

AMENDED ORDINANCE NO. 1970-1

AN ORDINANCE EXTENDING THE CORPORATE LIMITS OF THE VILLAGE OF Brownsdale TO INCLUDE CERTAIN UNINCORPORATED TERRITORY COMPLETELY SURROUNDED BY LAND WITHIN THE VILLAGE LIMITS AND ABUTTING THEREON.

WHEREAS, certain territory described below is not presently included within the corporate limits of any incorporated city, village, or borough; and

WHEREAS, THIS territory is completely surrounded on all sides by lands already included within the corporate limits of the village and is deemed to be urban in character;

The Village Council of Brownsdale ordains;

SECTION E. TERRITORY ANNEXED The corporate limits of the Village of Brownsdale, Minnesota, are hereby extended to include the platted territory described as follows; which territory now is and has heretofore been completely surrounded by territory already included within the village limits.

DESCRIPTION OF THE PROPERTY.

Commencing on the S.E. corner of C.L. 65 in the N.E.  $\frac{1}{4}$  of the N.E.  $\frac{1}{4}$  Section 9, T 103 N.R. 18W. Mower County, Minn. according to a plat thereof on record in Book 2 of Plats, page 4 in the Register of Deeds Office, the same corner also being the point of beginning thence north 35 rods of the section line, the same line also being the centerline of Th.#56, thence W. 13  $\frac{3}{4}$  rods, thence south 27 rods, thence E. 3  $\frac{3}{4}$  rods, thence south 8 rods, thence east 10 rods to the point of beginning.

SECTION 2. FILING. The village clerk is directed to file certified copies of the ordinance with the Secretary of State, the County Auditor of the county in which the property is located, and the Minnesota Municipal Commission.

SECTION 3. EFFECTIVE DATE OF ANNEXATION. This ordinance takes effect upon passage and publication and the filing of certified copies as directed in section 2.

Adopted by the Village Council of Brownsdale, Minnesota,  
Feb 2, 1970.

ATTEST:

Mrs August Larsen

(CLERK)

Wm H. Stanton

(MAYOR)

PUBLISHED IN Austin Herald,  
Feb 7, 1970



294436

Clerk of Registrar of Deeds } SS.  
Mower County, Minnesota }

I hereby certify that the within instrument was filed for record on the 3 day of Aug A.D., 1970 at 10:30 o'clock A.M. and duly recorded in book 31 of Misc on page 163.

By Paul M. Eng Registrar of Deeds  
Charles Eng Deputy

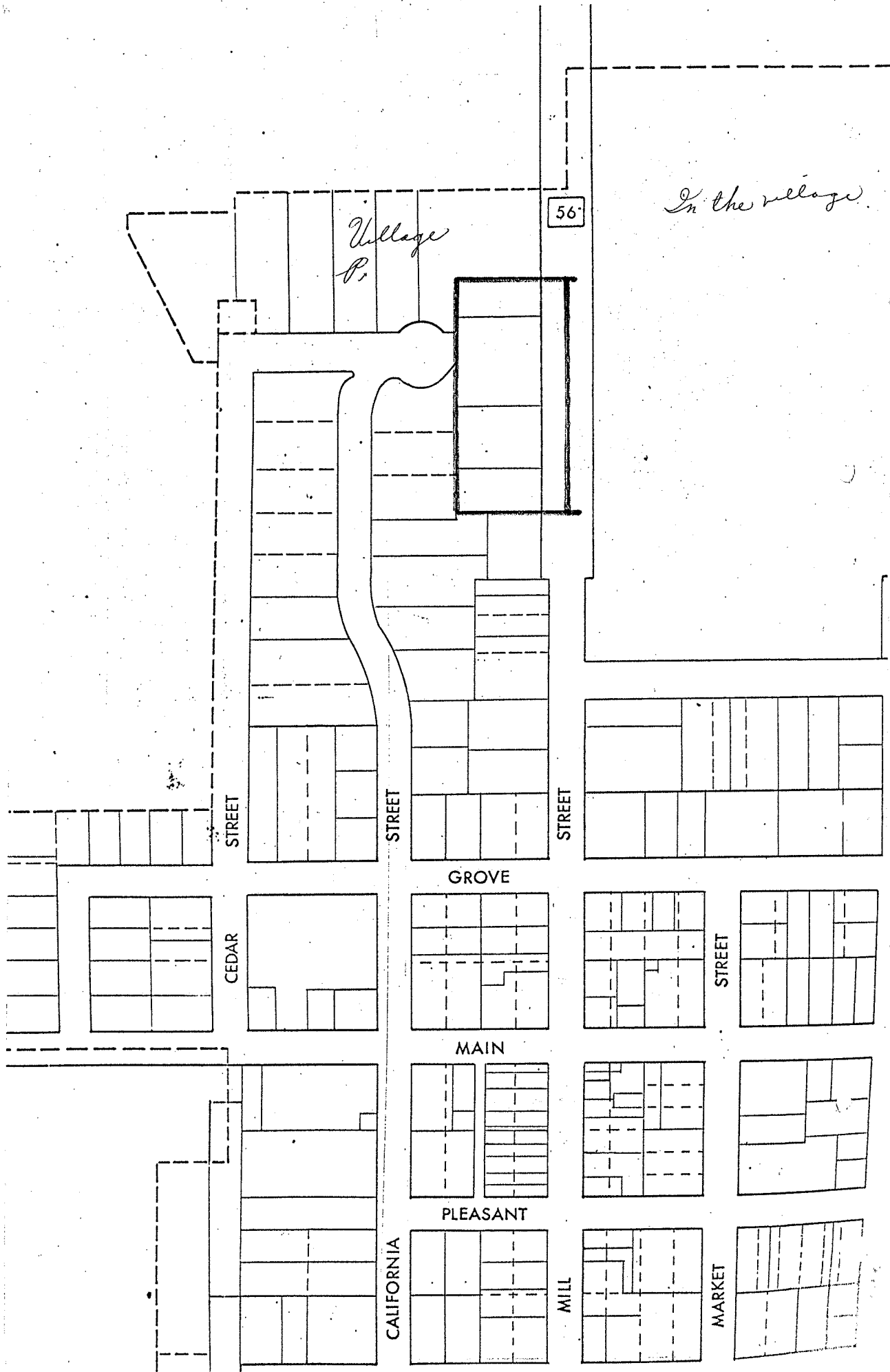

Village  
P.

56

*In the village*

STREET

STREET

STREET

CEDAR

GROVE

MAIN

PLEASANT

CALIFORNIA

MILL

STREET

MARKET